

PROPOSED PLANT SCHEDULE					
Code	Botanical Name	Common Name	Approx mature height, spread	Pot size	Quantity
GROUND COVERS, SMALL SHRUBS					
12	<i>Vibula hederacea</i>	Native Violet	.2 x .8	100mm	62
3	<i>Senecio mandarinocoe</i>	Blue Chalk Sticks	.3 x .6	150mm	10
4	<i>Dichondra Silverfalls</i>	Silverfalls	.1 x .9	100mm	87
5	<i>Liriope 'Evergreen Giant'</i>	Lily Turf	.4 x .5	150mm	22
6	<i>Ophiopogon 'Alba Variegata'</i>	Variegated Mondo Grass	.4 x .4	100mm	3
7	<i>Cuscutaria 'Cousin It'</i>	Cousin It	.3 x .9	150mm	1
9	<i>Pandorea pandorana</i>	Wonga Wonga Vine	n/a	200mm	8
10	<i>Dianella caerulea</i>	Blue Flax Lily	.4 x .5	150mm	16

SHRUBS, FERNS				
11	<i>Lemnandra "Tonika"</i>	Dwarf Mat Rush	.6 x .6	150mm
12	<i>Grevillea sericea</i>	Pink Spider Flower	1.2 x .7	200mm
13	<i>Crinum pedunculatum</i>	Swamp Lily	.8 x .8	200mm
14	<i>Indigofera australis</i>	Native Indigo	1.2 x .9	200mm
15	<i>Phllothecca myoporoides</i>	Long Leaf Wax Flower	.7 x .5	200mm
16	<i>Gardenia augusta "Florida"</i>	Gardenia	.8 x .8	200mm
18	<i>Camellia "Mine-No-Yuke"</i>	Sasanqua	1.2 x .7	300mm
22	<i>Syzygium australe "Pinnacle"</i>	Lilly pillly	1.3 x .6m	300mm
24	<i>Leptospermum polygalifolium</i>	Yellow Tea Tree	3 x .8m	300mm
25	<i>Callistemon "Endeavour"</i>	Bottlebrush	2.2x1.2m	45 litre
31	<i>Alcantaria imperialis</i>	Alcantaria	1 x 1m	300mm
33	<i>Cyathea cooperi</i>	Lacy Tree fern	4 x2.5m	300mm
34	<i>Cordyline fruticosa</i>	Ti Plant	1.5x1.2m	200mm

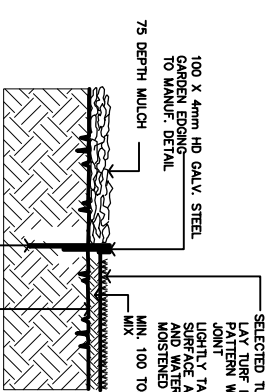
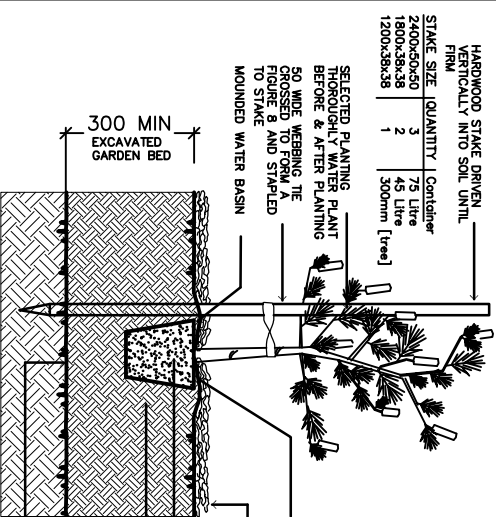

**NOTES:**

- 1 Contractors must verify all dimensions at the site before commencing any work or construction. All dimensions must be approved before manufacturing.
- 2 Do not scale drawing, if in doubt – ASK
- 3 This drawing is to be read in conjunction with Architectural, Hydraulic and survey plans
- 4 All Existing trees to remain shall be protected as per arborist report & council requirements, **UNLESS NOTED OTHERWISE** on the drawing.
- 5 All pruning shall be in accordance with the AS 4373
- 6 Thoroughly eradicate weeds from all garden areas.
- 7 No vegetation to the works to be carried out without prior approval from owner.
- 8 All materials to be the best of their respective kinds and shall comply with specified sample type submitted or specified.
- 9 Substitution of plant species or varieties will 10 not be permitted.
- 11 Unless otherwise specified or directed, all works shall be carried out by the consulting landscape architect.
- 12 All storm water outlets & surface run off shall be suitably hydraulic Engineers detail. Erosion control measures shall be in place, prior to commencement of landscape work.
- 13 Provide suit-soil drainage to garden beds & lawns where required – To be confirmed on site.
- 14 Refer to survey plan for position of all existing services.
- 15 Refer to Architectural elevations & Sections for existing and proposed ground lines.
- 16 All landscape works shall comply with all council DA & CC conditions and all relevant "AUSTRALIAN STANDARDS" and AS2-SPEC NO.1 Specification
- 17 C22.3-Landscaping.
- 18 Irrigation system – Fully automatic operated system to all areas shall be designed & installed to comply with AS 1552, AS 1553, AS 1554, AS 1555, AS 2869.3-1990, Sydney Water and other relevant authority regulations.
- 19 **MAINTENANCE** – All landscape works are to be maintained for a period of 52 weeks after final completion. Replace all plants which have failed with the same species. Mulch is to be maintained at specified levels on a regular basis to maintain moisture levels required for optimum growth. All garden areas are to be maintained free from weeds.

Refer to arborists report for all locations and species names of trees to be removed

Issue	Amendment	Date
A	Preliminary	3.05.23
B	For DA	11.07.23

## PROPOSED PLANT SCHEDULE

HARDWOOD STAKE DIMEN.

STAKE SIZE (QUANTITY)

2400x25x50	2
7/8" DIA. x 50' LONG	1

300mm [max]

SELECTION PLANTING  
THROUGHOUT WATER PLANTING  
50' LINE & 10' LINE PLANTING  
FORCED TO FOLLOW THE  
TO STAKE AND STAYED  
MOUNDING WATER BARR

300 MIN  
EXCAVATED  
GARDEN BED

TREE & SHRUB PLANTING IN GARDEN BED

NOT PLANT IN UNSTABLE WEATHER CONDITION

The diagram illustrates a cross-section of a raised garden bed. At the top, a plant with large leaves is shown. Below it, a layer of mulch is indicated by a line and labeled "75 GERM MULCH". The main body of the bed is divided into several horizontal layers, each with a specific label and a corresponding symbol:
 

- PLACED FERTILIZER FLAKES:** Indicated by a symbol of a small circle with a cross inside.
- FERTILIZER, MOISTURE, AND OXYGEN:** Indicated by a symbol of a small circle with a dot inside.
- TO AIR PLANT TUBES:** Indicated by a symbol of a small circle with a vertical line through the center.
- SALTATIVE FOOTBALL:** Indicated by a symbol of a small circle with a horizontal line through the center.
- SUB-GRASS BROWN:** Indicated by a symbol of a small circle with a diagonal line through the center.
- UP TO 100 GERM TO FALL TO:** Indicated by a symbol of a small circle with a cross inside.
- CLAY SOIL SHALL BE MOVED:** Indicated by a symbol of a small circle with a dot inside.
- GLASS SOIL SHALL BE MOVED:** Indicated by a symbol of a small circle with a vertical line through the center.
- MAINT. SPEC:** Indicated by a symbol of a small circle with a horizontal line through the center.

 The bottom of the diagram shows a layer of soil with a wavy texture, labeled "SUB-GRASS BROWN".

[illegible]

WALLMAN PARTNERS PTY LTD

Endemic species: – Canterbury Bankstown LGA

---